



# 21<sup>st</sup> Century School Buildings Plan

Calverton Essential Elements | February 2, 2016



## Introductions

### **Nicole Price**

Director, Public Relations

21<sup>st</sup> Century School Buildings Program

### **Alice Burley**

Program Manager, Feasibility Study

21<sup>st</sup> Century School Buildings Program

### **Education Planner**

City Schools

## Agenda

### **Introductions**

### **21<sup>st</sup> Century Buildings Overview**

- History & Funding
- Partnership & Responsibilities
- Terminology

### **Engagement, Process & Timeline**

### **Educational Specifications**

- Essential Elements,
- Calverton Specific Spaces

### **Values & Priorities**

### **Next Steps**

# 21<sup>st</sup> Century School Buildings Vision

- Invest to support academic success for all students
- Maximize fiscal responsibility and stewardship of resources
- Engage school communities to inform the creation of excellent school buildings for their students
- Align school buildings with demographics trends, enrollment trends, and parent and student choices
- Invest to have maximum impact on community stability, growth, or development
- Provide diverse options in every geographic area of the city
- Create school buildings on the cutting edge of technology and environmental sustainability

## **Investment in buildings, students and communities**

**Overall school revitalization project has three goals:**

- (1) to transform student opportunities and achievement;
- (2) improve engagement and wellbeing of communities;
- (3) help revitalize neighborhoods and communities.

# 21<sup>st</sup> Century School Buildings Program Update

The Baltimore City Public School System (City Schools) Construction and Revitalization Act of 2013 resulted in a partnership between:

- The State of Maryland
- Baltimore City
- City Schools

***Each contribute \$20 million*** annually towards the plan.

Current estimates suggest the funding stream will support:

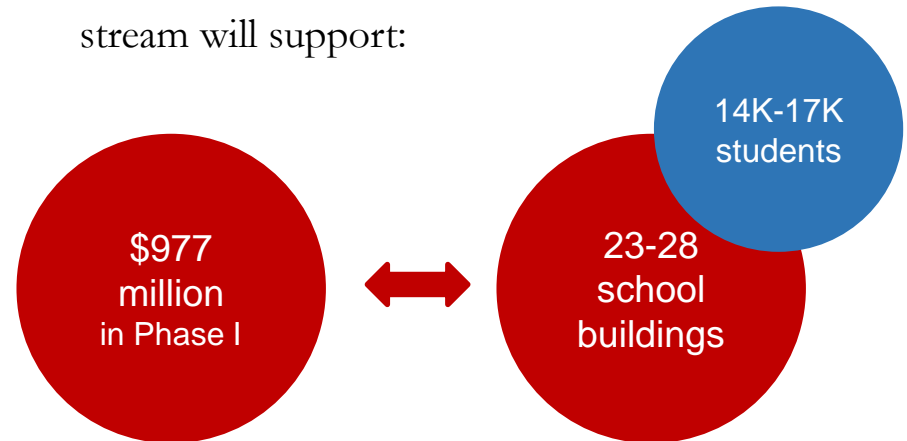

City Schools' Plan is one of the largest public works project in Baltimore City to date.

## Overview: Partnership Structure



# *What is an Educational Specification?*

## Educational Specification (Ed Spec)

- include the *essential elements of design* or required learning environment features, characteristics and overall design goal for *21<sup>st</sup> Century schools*.
- general guidelines, options and considerations that will guide each school-level planning process.

### *The site specific Ed Specs take into consideration:*

- Decisions regarding the number of classrooms by grade, for certain subjects, the relationship of one space to another, special built-in equipment, and a host of physical features.

# Feasibility Study

A **Feasibility Study** is an analysis of the existing condition of site and building components to include systems, elevations, other planning and design considerations.

The study will produce a minimum of three possible solutions (renovation & replacement options) that address:

Educational Specifications, determine building deficiencies or ability to accomplish goals of the project

Budgets, including Forty-Year Life Cycle, and schedule for all options



# Summary of Activities: Timeframe



**Planning**

**Design**

**Construction**

**Occupancy**

**18-24 Months**

**18-24 Months**



**Planning: 6-8 Months**  
**December 2015 – July 2016**

Dates subject to change

**Meeting #1**  
**Orientation**

1. Review process
2. Learn key terms
3. Interactive activity

**Jan 14<sup>th</sup> 2014**

**Meeting #2**  
**Essential Elements**

1. Explore essential elements of design

**Feb 2<sup>nd</sup> 2016**

**Meeting #3**  
**50% Feasibility Study**

1. Review site & building options
2. Provide feedback

**March 2016**

**Meeting #4**  
**Feasibility Review**

1. Make recommendation on building option

**June 2016**

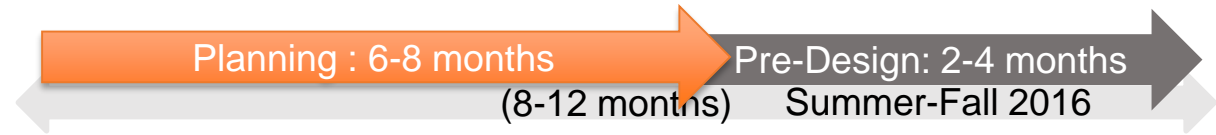

## Feasibility Review

- School stakeholders provide feedback on building recommendation, June
- City Schools staff review stakeholder recommendation and other criteria
- 21<sup>st</sup> Century staff work with MOU partners to finalize recommendation

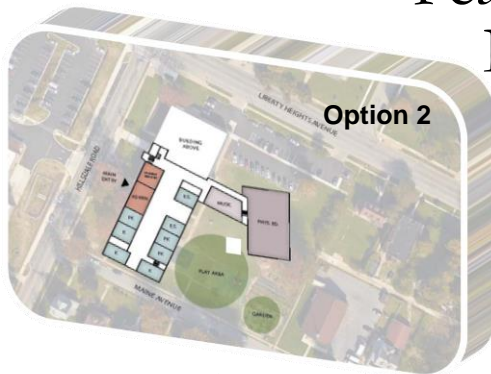

## Option 3

## Selection

- Board of School Commissioners Approval, July
- Notification to Maryland Stadium Authority
- Interagency on School Construction Approval
- Design Architect/Engineer Request for Proposal
- Award A/E and construction managers

# Design

Planning : 6-8 months

Pre-Design: 2-4 months  
18-24 months

Design: 10-12 months  
Winter 2016



**Design: 10-12 Months**

## Meeting #5 Concept



## Meeting #6 Schematic



## Meeting #7 Design Development



## Meeting #8 Final Drawings





# Transform student opportunities and achievement;



**21<sup>st</sup> CENTURY SCHOOLS**  

---

**BALTIMORE**

Educational specifications that support innovative,  
high-quality teaching and learning...

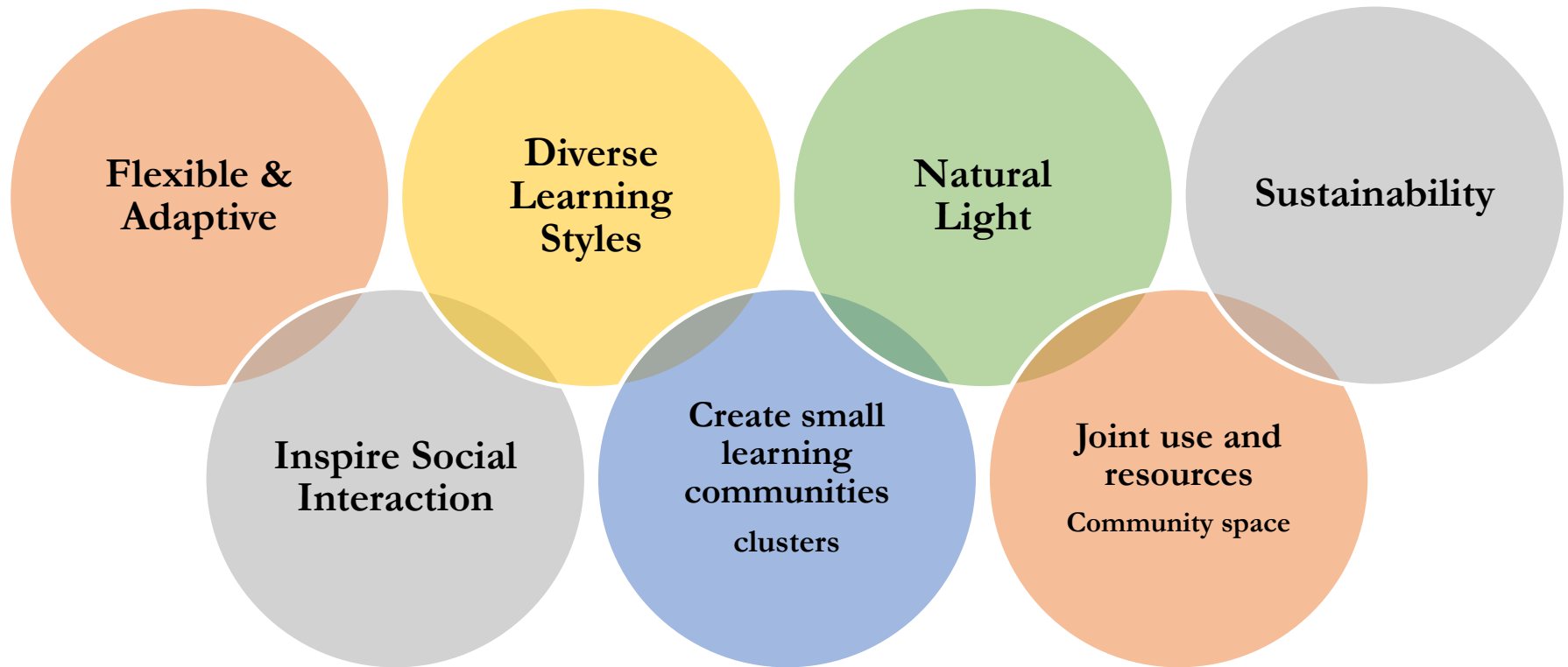

# Learning Environments

## Where in the spectrum should City Schools be?

### 1. Traditional rows of classrooms

All private spaces with no shared space.

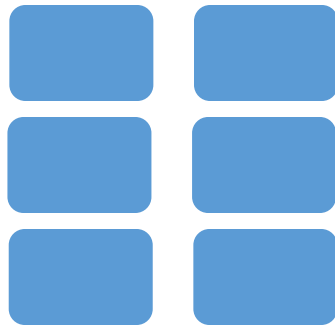

### 2. Corridor breakout space

Private classrooms with small group work area.

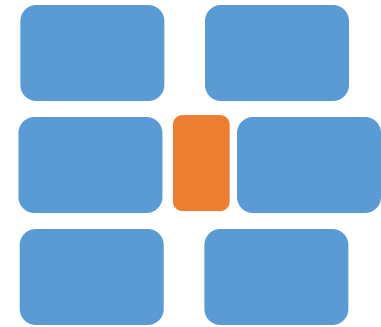

### 3. Collaborative space

Classroom area designated as shared space.

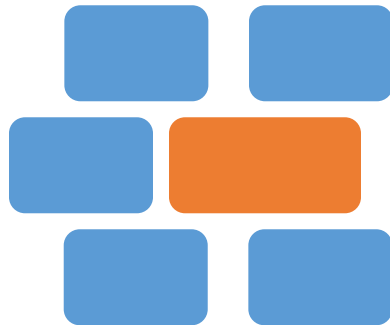

Teacher “owned” classroom.

### 4. Shared spaces

Variety of space types all for shared use.



Teachers move and share classrooms

## 21<sup>st</sup> Century Learning Spaces: *Cluster Approach*

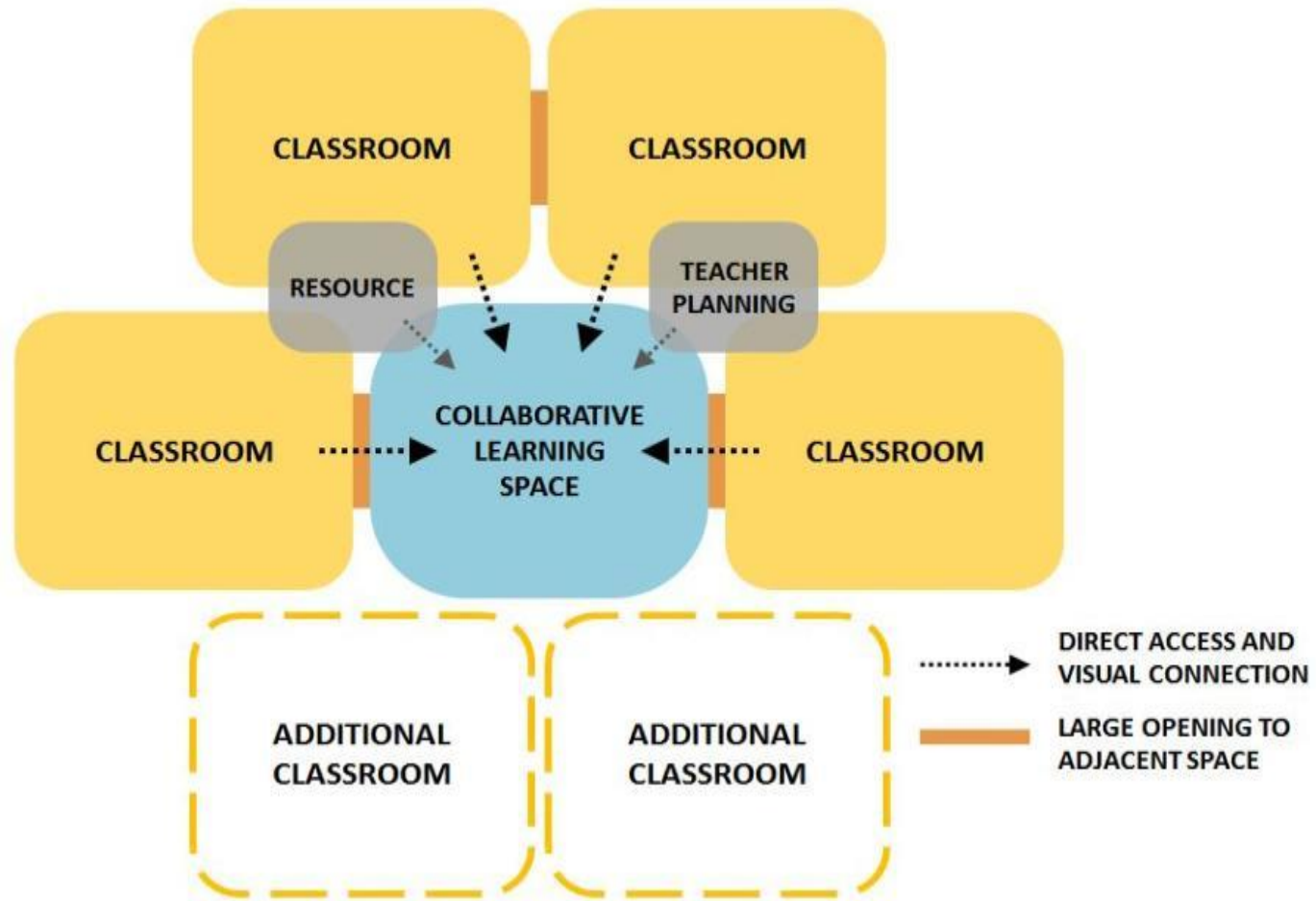



## 21<sup>st</sup> Century Learning Spaces: *Cluster Approach*

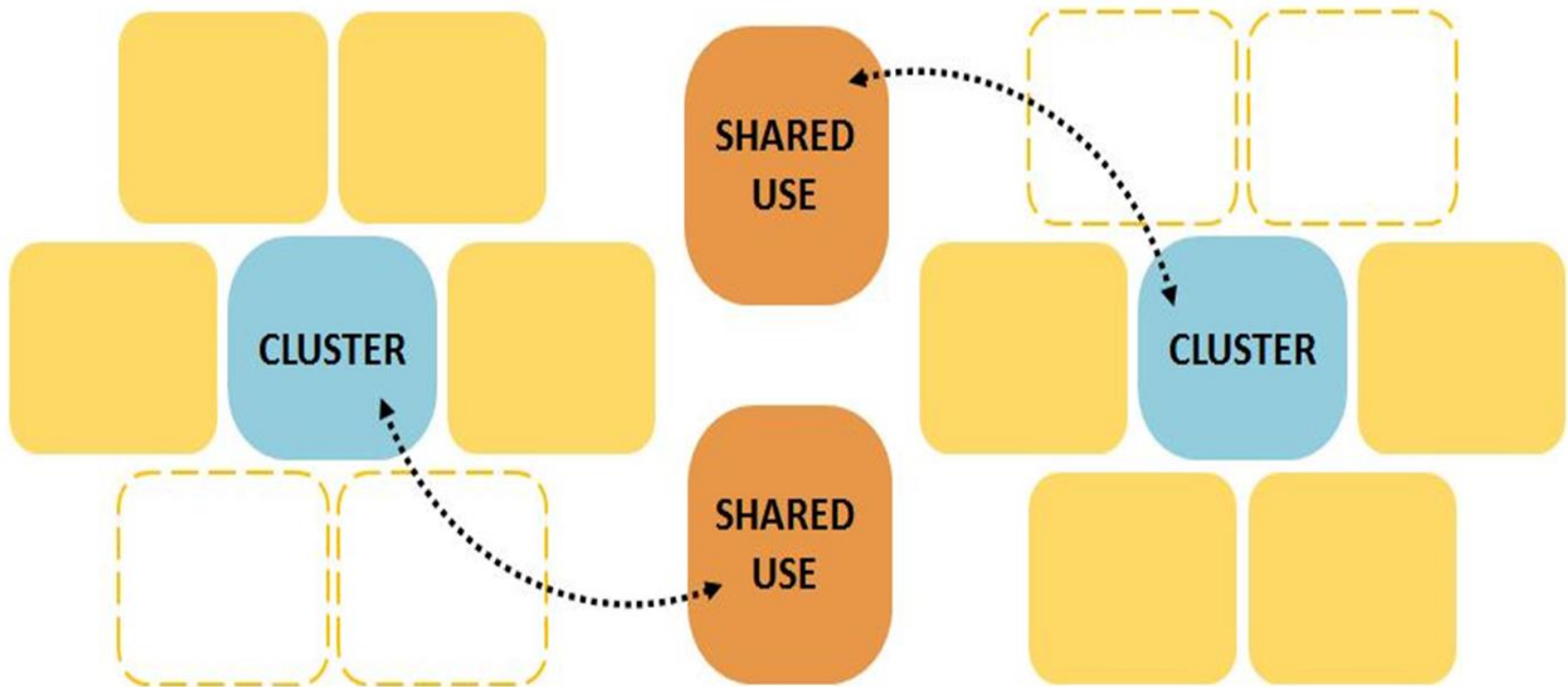

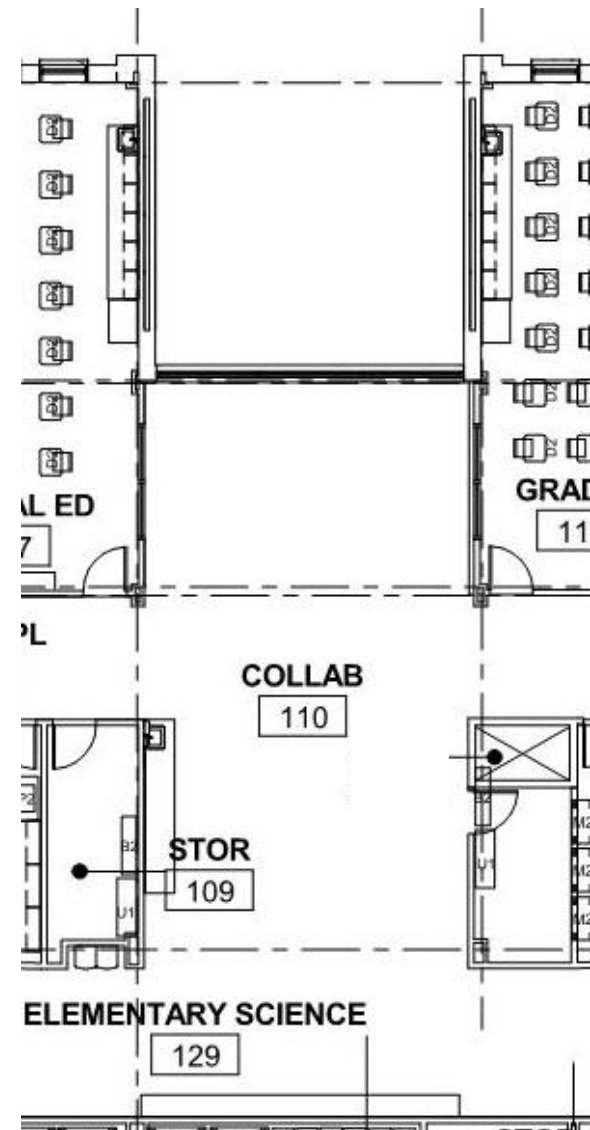
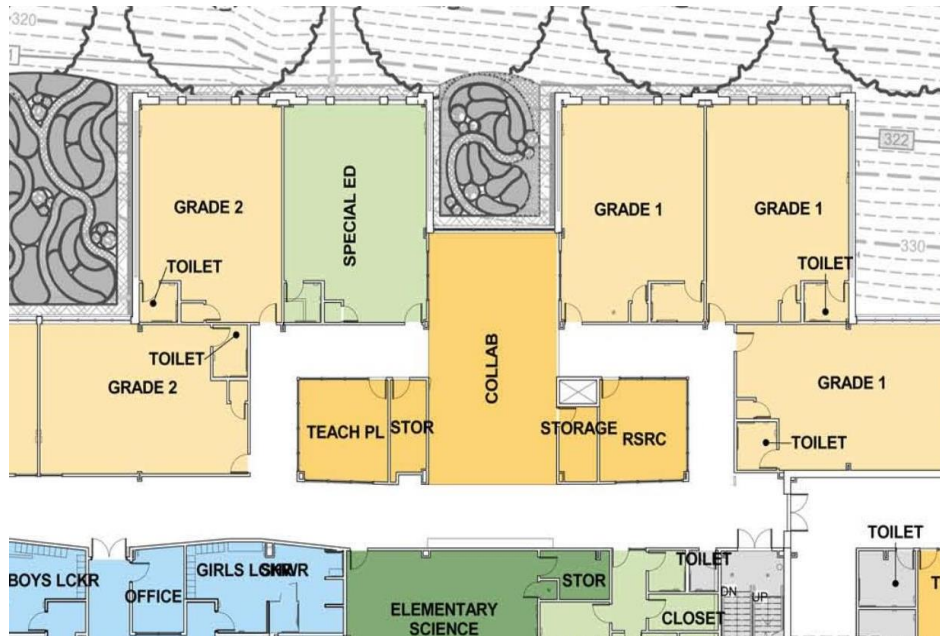

## Lyndhurst Sample Classroom and Collaborative Space Cluster

*Flexible and adaptive space* so learning can happen anywhere:  
collaborative spaces, movable walls, display boards



*Interactive social areas* that incorporate technology





*Interactive social areas* that incorporate technology



## 21<sup>st</sup> Century Characteristics

***Engaging spaces*** that support diverse instructional delivery: interactive learning labs, outdoor classrooms



***Spaces that encourage student and teacher collaboration:*** team-based learning, live streaming, collaborative teaching,





## Natural Lighting





*Multifunctional spaces designed* for joint partner, community & parent use

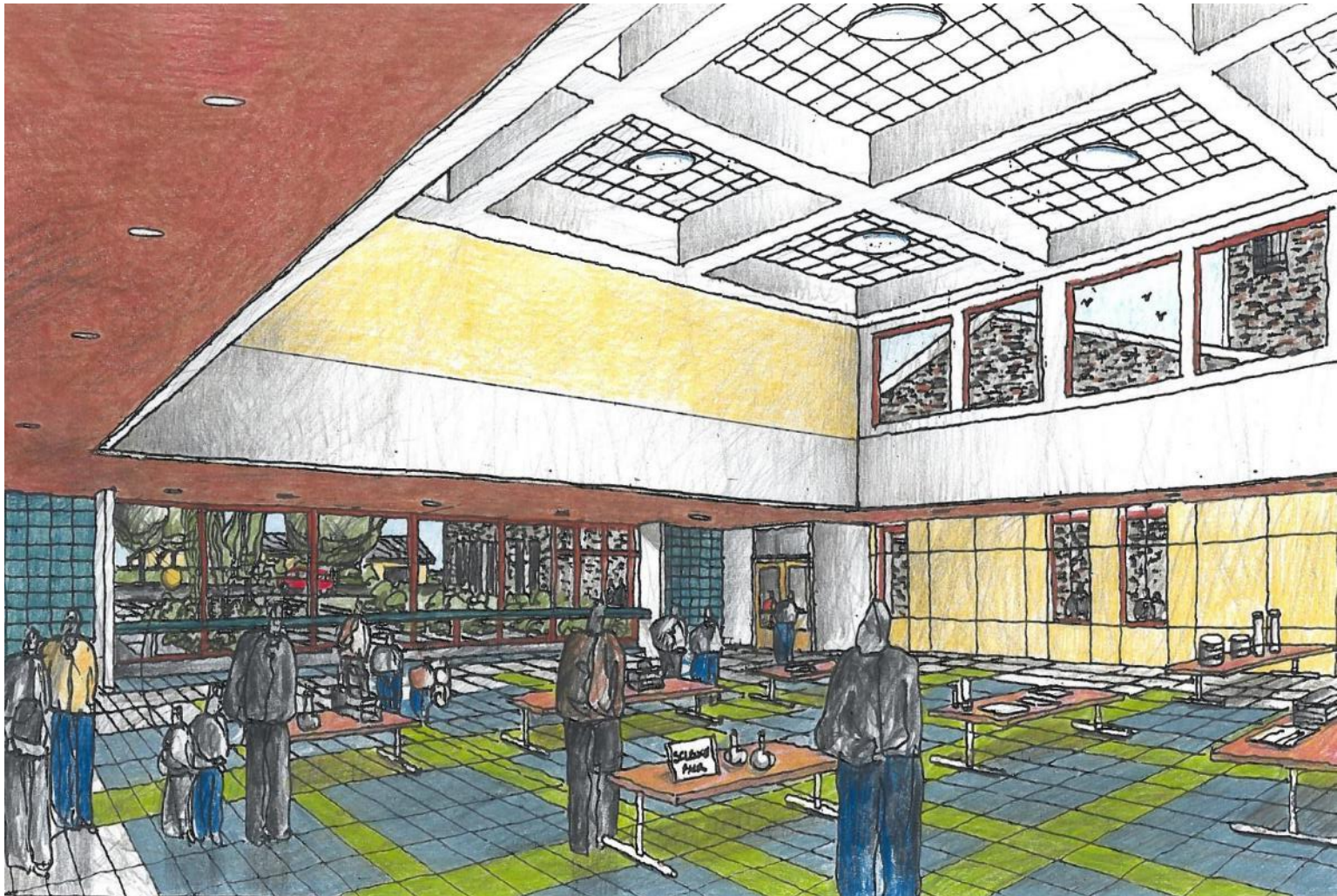



# Calverton Elementary/Middle



**21<sup>st</sup> CENTURY SCHOOLS**

**BALTIMORE**

# Calverton Classrooms and Spaces

6 Pre K and Kindergarten classes	3 middle school science rooms
6 classrooms for grades 1 and 2	2 technical education classroom
9 classrooms for grades 3, 4, and 5	2 Foreign Language classrooms
18 classrooms for grades 6, 7, and 8	2 music rooms
3 flex classrooms	2 art rooms
8 collaborative learning areas	Gateway to Technology Lab
4 special education classrooms	Media/Video Studio
2 ELEA classrooms	Cafeteria
1 Let's Grow Classroom	Gymnasium, Dance Studio
1 Discover with Me classroom	Student Services
3 MS PRIDE classrooms	Community Space
1 elementary science room	Administrative/Health Suites

# Improve engagement and wellbeing of communities



**21<sup>st</sup> CENTURY SCHOOLS**

**BALTIMORE**

## **City Schools holds as a core belief that ...**

“Spaces in the school should be designed to support community partnering and involvement. After-hours use should be both a goal and a reality for each building, as the resources community institutions bring to students after school hours can support school success and the school can provide much needed space for community programs that help build community success.”

Examples of community resources and partnerships in schools...

**Non-City run  
Daycare or Pre-  
School Programs**

**Health Suites**

**Food Pantry**

**Mental Health  
Services**

**Family  
Support  
Services**

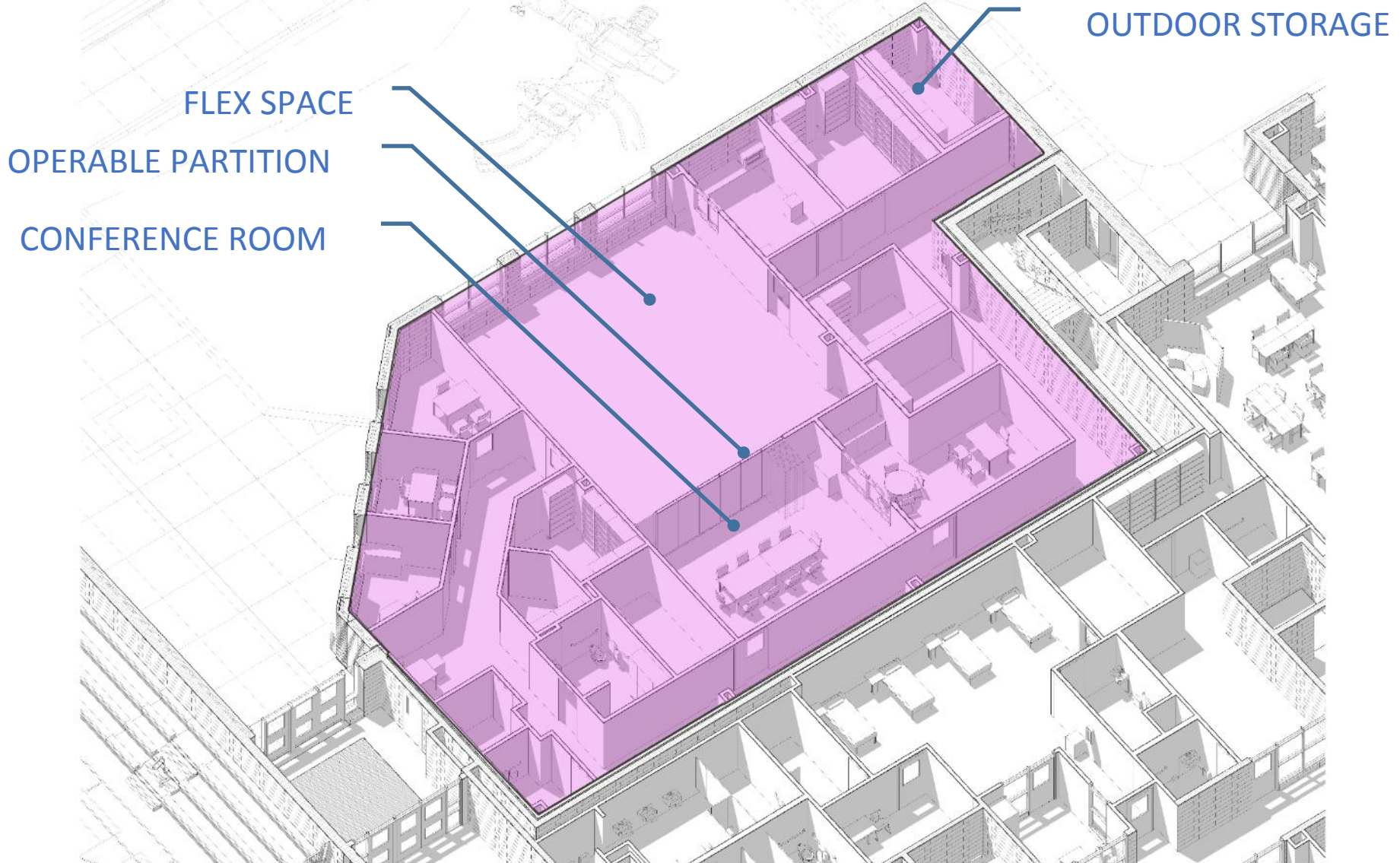

## Fort Worthington Sample Community/Partnership Space



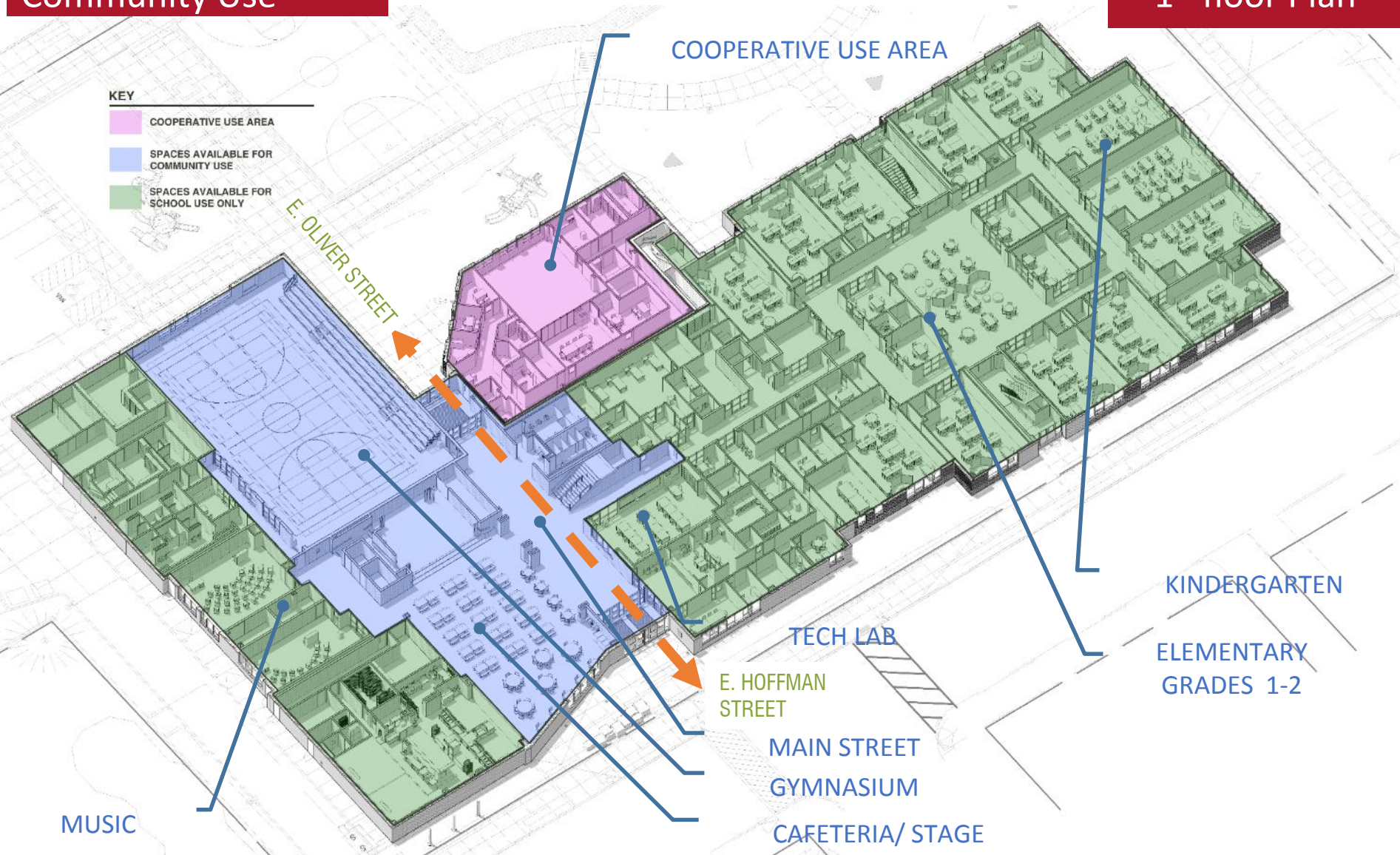

# Buildings Community School Planning Process: Facilities Phase

1. Building the Planning Team
2. Data Review and Planning
3. Surveying Stakeholders
4. Community Forums
5. Review Priority Areas

## Building the Community School Planning Team

- The Community School Planning Team should be comprised of families, staff, community members and school partners who can represent their stakeholder groups and provide assistance with the planning and implementation of the community school engagement strategies.
- A common vision and understanding around the logistics and expectations of team members should be discussed and agreed upon to ensure effective functioning.



## Community School Planning Team Data Review and Planning

- Planning team will review asset maps, climate survey and BNIA data, as well as other sources available to identify preliminary areas to assess.
- Team will make determination of what indicators will be included in facilities-focused survey for stakeholders.

## Surveying Stakeholders

- Survey structure developed by Family League with detailed areas of interest identified by Community School Planning Team.
- Survey distributed to families, staff, community representatives and school partners.
- Survey data entered into database created by Family League.



## Community Forums

- School community's opportunity to complete additional surveys and facilitate smaller focus-groups and discussion opportunities will deepen the exploration of areas identified through High-level Survey.
- School community will create a list of priority areas to be explored as possible community-use space in the design process.

## Community School Planning Team and Family League Review Priority Areas

- With the assistance of Family League, Community School Planning Team will review the priority areas identified by the school community to determine areas that have facilities impact.
- Family League and Community School Planning Team complete a decision-making matrix that will help identify gaps in services and partners that impact the formal recommendations to the School Design Team.



Following the facilities-focused activities, Community School Planning Teams will use the information gathered to begin planning and designing a comprehensive community school strategy.



MAKING CONNECTIONS. IMPROVING LIVES

Community Meeting: "Essential Elements" | Calverton | February 2, 2016 | [www.baltimore21stcenturyschools.org](http://www.baltimore21stcenturyschools.org)

# Help revitalize neighborhoods and communities.



**21<sup>st</sup> CENTURY SCHOOLS**

---

**B A L T I M O R E**



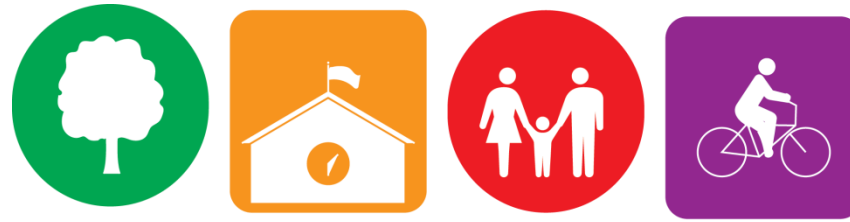

# INSPIRE

Investing in Neighborhoods and Schools to Promote  
Improvement, Revitalization, and Excellence

- **Through INSPIRE, Baltimore City Department of Planning is leading planning processes for the ¼ mile area surrounding each of the 21<sup>st</sup> Century Schools.**
- **INSPIRE aims to create a supportive environment for local students and residents by strengthening the connection between the renovated school and the surrounding neighborhood.**
- **Each plan will express the community's vision and strategy for investment in their neighborhood including specific, implementable public projects in areas such as transportation, housing, and open space.**
- **All stakeholders are welcome to participate in the planning process. To learn more about the process or how you can become involved visit the **INSPIRE** page of the Department of Planning's website (<http://www.baltimorecity.gov/Government/AgenciesDepartments/Planning>)**

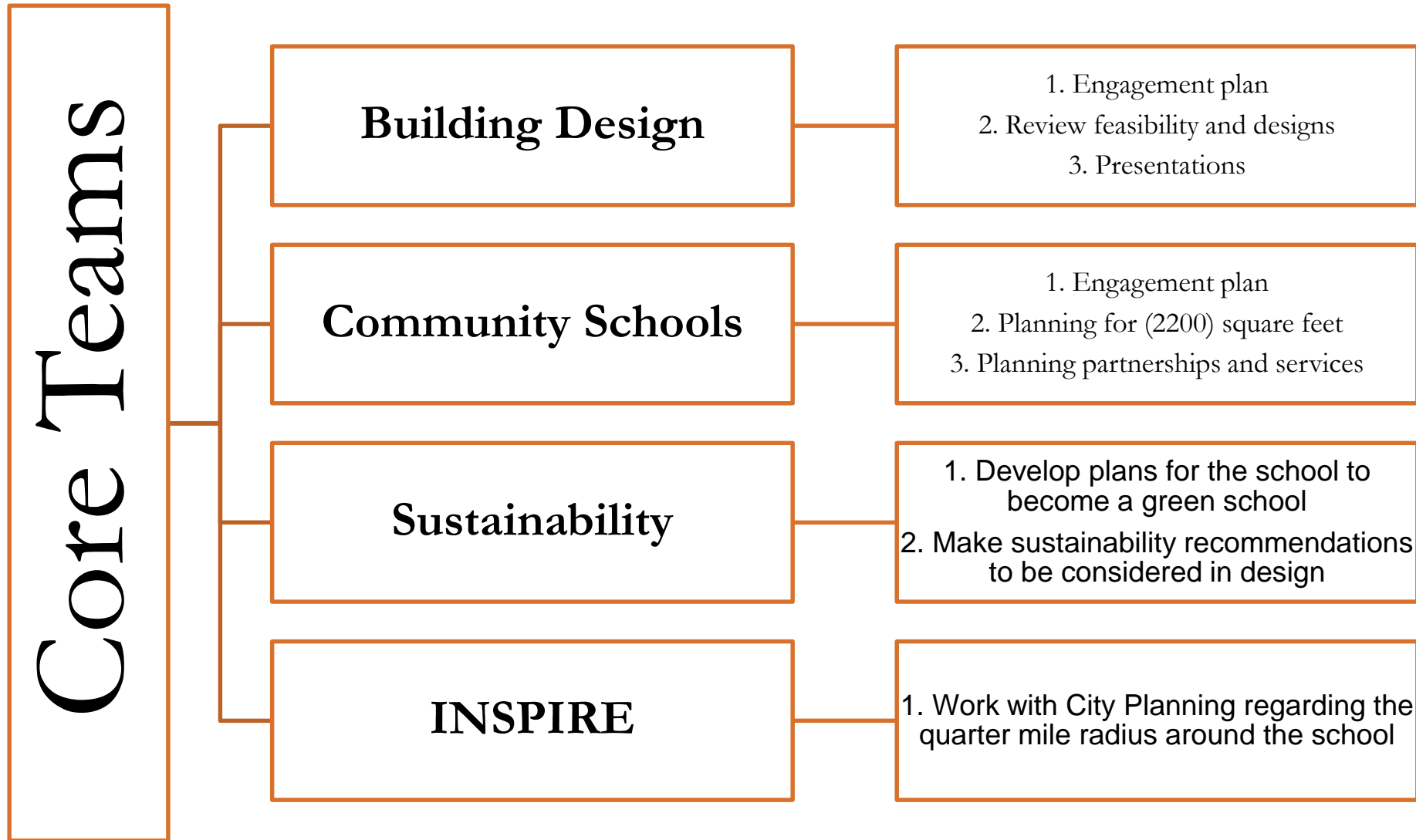

## Timeline & Next Steps

February

- Establish and host core team meeting
- 50% Feasibility submission due, February 22<sup>nd</sup>

March

- Core team meeting
- Core team host school-wide meeting with all stakeholders, review 50% submission

April

- Core team meeting, review 50% Feasibility Study survey results

May

- Final Feasibility Study submission due, May 23<sup>rd</sup>

June

- Core team host school-wide meeting, review Feasibility Study
- Core team make recommendation to 21<sup>st</sup> Century Buildings Office

Thank You!



This presentation is brought to you by the  
21<sup>st</sup> Century School Buildings Program.

[www.baltimore21stcenturyschools.org](http://www.baltimore21stcenturyschools.org)

**21st Century School Buildings Program**

Baltimore City Public Schools  
200 East North Avenue Room 407-B  
Baltimore MD 21202  
(443) 642-4600

**Mignon R. Anthony**

Executive Director, 21st Century Buildings Program  
Baltimore City Public Schools

**Gary McGuigan**

Senior Vice President, Capital Development Division  
Maryland Stadium Authority

**Dawn Kirstaetter**

Deputy Mayor, Health, Human Services, Education and Youth  
City of Baltimore

**David Lever**

Executive Director, Public School Construction Program  
State of Maryland

BALTIMORE CITY  
PUBLIC SCHOOLS

