



21st Century School Buildings Program

Montebello Elementary / Middle School

COMMUNITY MEETING : Construction | June 21, 2022

BALTIMORE CITY
PUBLIC SCHOOLS



Project Team Members

Renee Stainrod

Manager, Community & Public Relations
21st Century School Buildings Program

Michael McBride

Interim Executive Director
21st Century School Buildings Program

Ivy D McNeill

Sr. Program Coordinator, Community & Engagement
21st Century School Buildings Program

Justin Wood

Project Manager
Maryland Stadium Authority

Vince Culotta

Senior Project Manager
CAM Construction

Todd Vukmanic

Project Manager/Architect
Crabtree Rohrbaugh & Associates, Architects

Agenda

Site Plan**Rendering Images****Construction Sequencing & Traffic****Project Schedule****Progress Photos****Questions & Contact Info**

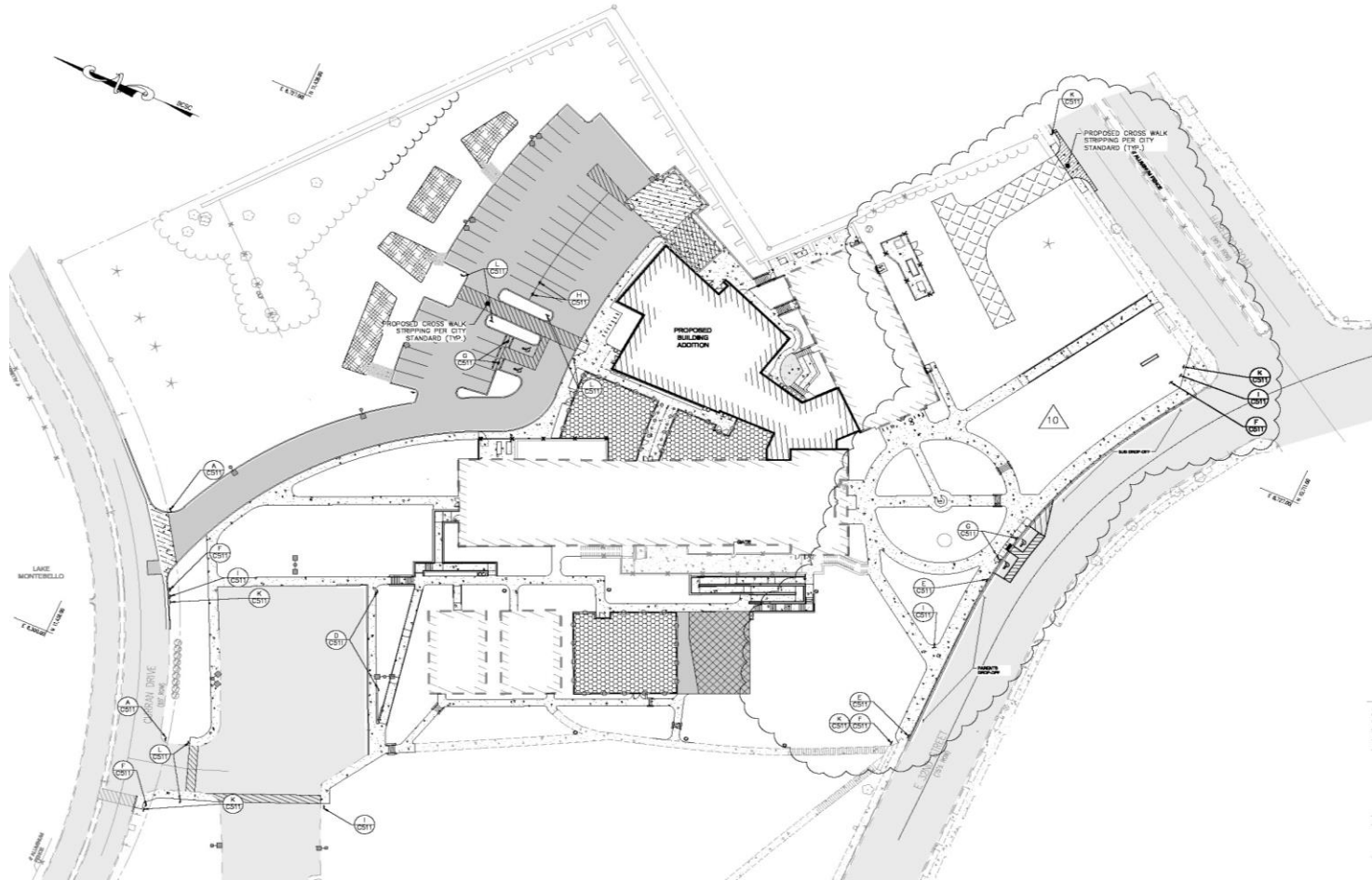













Construction Hours:

Monday to Friday

7:00 am to 4:00 pm



Security Features:

- 24 Hour Surveillance
(TrueLook & Mobile Video Guard)
- Site Perimeter Fencing
- Security Guard





ROAD CLOSURE

Curran Drive
Construction
Entrance/Emergency
Access Only –
Beyond This Point.



CONSTRUCTION:	Winter 2021/Summer 2022*
NTP:	Winter 2020/21*
Demolition:	February 2021– April 2021*
Construction:	April 2021 – December 2022*

** Dates listed are based on a projected schedule and are subject to change.*



Existing Building A: 4-Story Portion
 Existing Building B: 2-Story Adjacent to Harford Rd.
 Building C: New Addition

ITEM #	DESCRIPTION
1	Start Site Utilities / Grading – 32 nd St/Harford Rd.
2	Complete Windows – Building B
3	Complete Windows – Building A & New Addition
4	Install Bulkheads (Final Stage) - Building B
5	Complete Floor Prep – Building A
6	Complete Casework – Building A & B
7	Complete Lockers – Building A & B
8	Install Visual Display Units – Building A & B
9	Install Bathroom Fixtures – Building A & B
10	Install Metal Doors & Hardware – Building A & B



Building A: (Existing)
Main Entrance on 32nd St.

Masonry Restoration in Progress





Building A & B: (Existing)

Site Improvements at Main Entrances to Existing Buildings A & B





Building A: (New Addition)

Installation of ADA Ramp & Stairs to Playground Area/Pavillion.





Building C: (New Addition)

New Stairwell in Building C (New Addition). View of Lake Montebello.





Building A: (Existing)

Construction of ADA Accessible Ramp & Stairs



Building A: (Existing)

Interior Finishes





Building A: (Existing)

Interior Finishes





Existing Building A: (Interior of Science Room)

Interior Finishes &
Casework in Science Room
on Level 2





Existing Building A: (Bathroom)

Installation of Fixtures



**Existing Building A:
(Corridor)**

Installation of Lockers



Building C: (New Addition)

Main Stair within the New Addition connecting Building A to Building B



WORKFORCE DEVELOPMENT



CALL (410) 396-3009

www.baltimore21stcenturyschools.org



@21stCenturySchoolBuildingProgram



Questions?

Program Contacts

Ivy D. McNeill
Sr. Community & Public Relations Coordinator
IDMcNeill01@bcps.k12.md.us

Renee Stainrod
Community & Public Relations Manager
rastainrod@bcps.k12.md.us

Program Information

21st Century School Buildings Program Office
(443) 642-4600



21stCSBaltimore



21stCenturySchoolBuildingsProgram



21stCSBaltimore



Thank you!

This presentation was brought to you by
the 21st Century School Buildings Program.

www.baltimore21stcenturyschools.org

21st Century School Buildings Program

Baltimore City Public Schools
200 East North Avenue Room 407-B
Baltimore, MD 21202
(443) 642-4600

Michael McBride

Interim Executive Director
21st Century School Buildings Program

Gary McGuigan

Executive Vice President, Capital Development Division
Maryland Stadium Authority

Faith Leach

Acting Executive Director
Mayor's Office of Children and Family Success

Alex Donahue

Acting Executive Director
Public School Construction Program
State of Maryland

BALTIMORE CITY
PUBLIC SCHOOLS

