



21st Century School Buildings Program

Montebello Elementary / Middle School

FINAL COMMUNITY MEETING : Construction | December 8, 2022

BALTIMORE CITY
PUBLIC SCHOOLS



Project Team Members

Renee Stainrod

Manager, Community & Public Relations
21st Century School Buildings Program

Michael Mc Bride

Design Director
21st Century School Buildings Program

Ivy D McNeill

Sr. Program Coordinator, Community & Engagement
21st Century School Buildings Program

Justin Wood

Project Manager
Maryland Stadium Authority

Vince Culotta

Senior Project Manager
CAM Construction

Todd Vukmanic

Project Manager/Architect
Crabtree Rohrbaugh & Associates, Architects

Agenda

Site Plan

Rendering Images

Site Mobilization Plan

Pedestrian Travel Path

Site Security

Road Closure

Project Schedule

Progress Photos

Workforce Development

Community Meeting Information

Questions & Contact Info

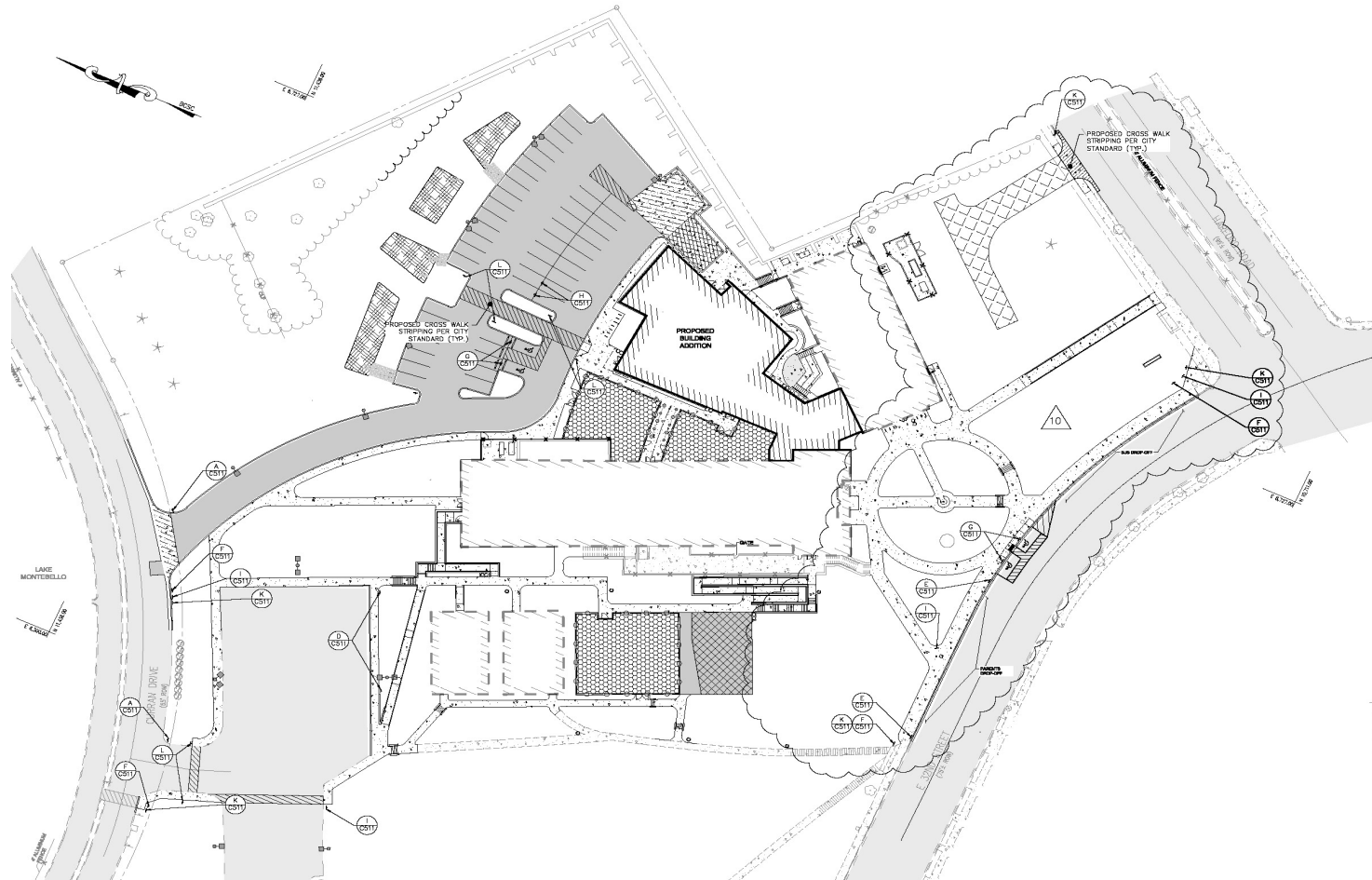













Construction Hours:
Monday to Friday
7:00 am to 4:00 pm



Security Features:

- 24 Hour Surveillance
(TrueLook & Mobile Video Guard)
- Site Perimeter Fencing
- Security Guard





ROAD CLOSURE

Curran Drive Construction Entrance/Emergency Access Only – Beyond This Point.

CONSTRUCTION:	Winter 2021/Summer 2022*
NTP:	Winter 2020/21*
Demolition:	February 2021– April 2021*
Construction:	April 2021 – December 2022*

** Dates listed are based on a projected schedule and are subject to change.*

Existing Building A: *4-Story Portion*
Existing Building B: *2-Story Adjacent to Harford Rd.*
Building C: *New Addition*

ITEM #	DESCRIPTION
1	Installation of Owner's Furnishings is 100% Complete
2	Final Inspection Process is 99% Complete
3	Finish Playground Equipment Install
4	Continue Commissioning of Mechanical/Electrical Systems
5	Commissioning/Testing of A/V Systems in progress
6	Commissioning/Testing of IT Systems in progress
7	Complete Final Stage of 32 nd Street Site Improvements
8	Continue Site Improvements on Harford Road
9	Complete Construction of Rear Access Road



Building A (Existing):

Main entrance from 32nd Street

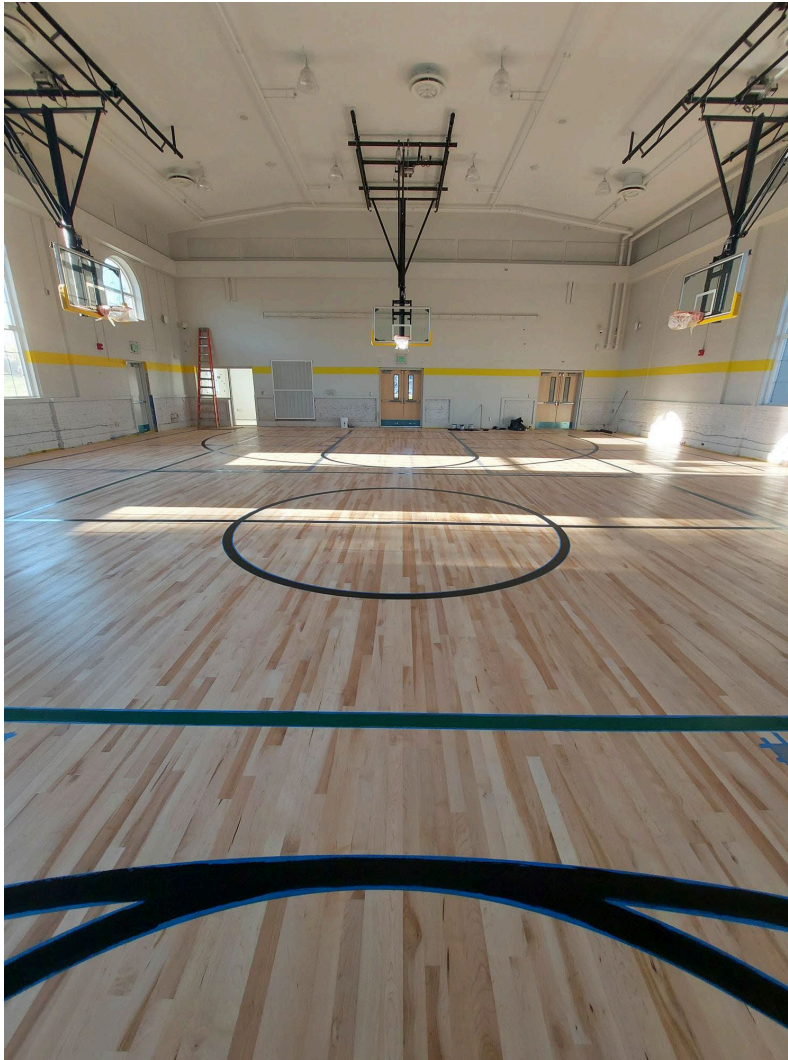

Building B (Existing):

Gym – Basketball court

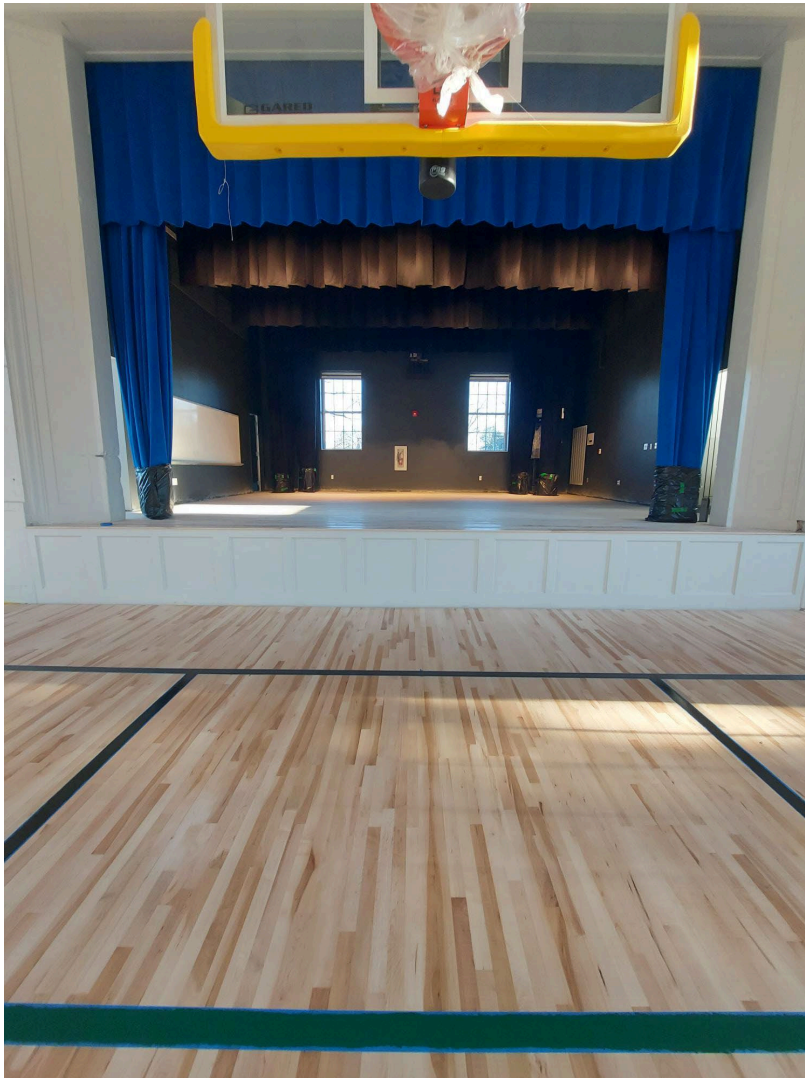

Building B (existing):

Gym & Stage



Building A (existing):

Classroom facing 33rd Street / Park



Building A: (Existing)

Science Room

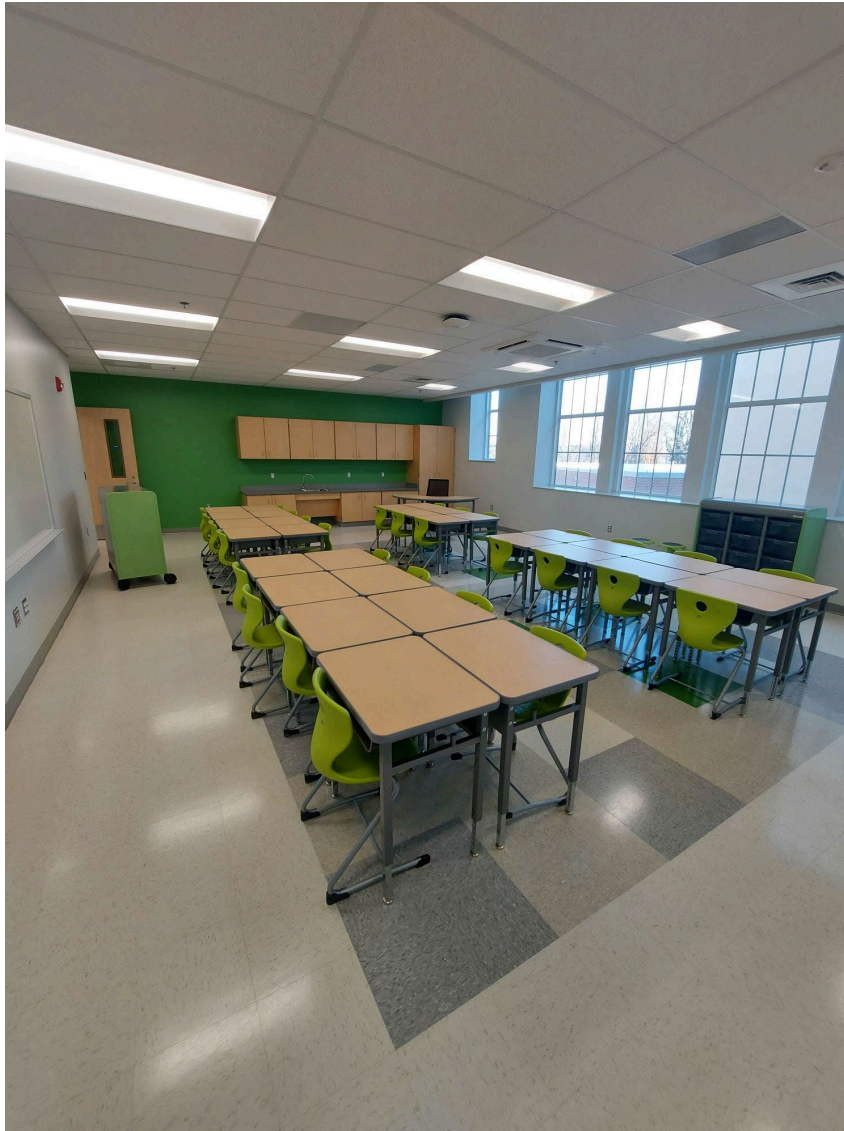

Building A (Existing):

Classroom Facing Cafeteria



Building C (new):

Cafeteria Facing Rear Parking Lot



New Addition (Building C):

Kitchen



Building A (Existing):

Kindergarten Classroom Facing
33rd Street / Park



Building A (Existing):

Corridor within 4-story building



**Buildings A (existing) & C
(addition):**

Playground between New
Addition and Existing Building



**Building C (addition) & Building
A (existing):**

Playground facing New Cafeteria

WORKFORCE DEVELOPMENT



CALL (410) 396-3009

www.baltimore21stcenturyschools.org

@21stCenturySchoolBuildingProgram

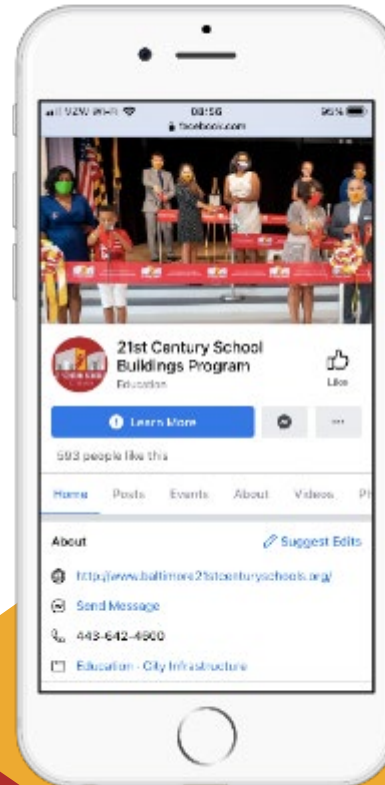
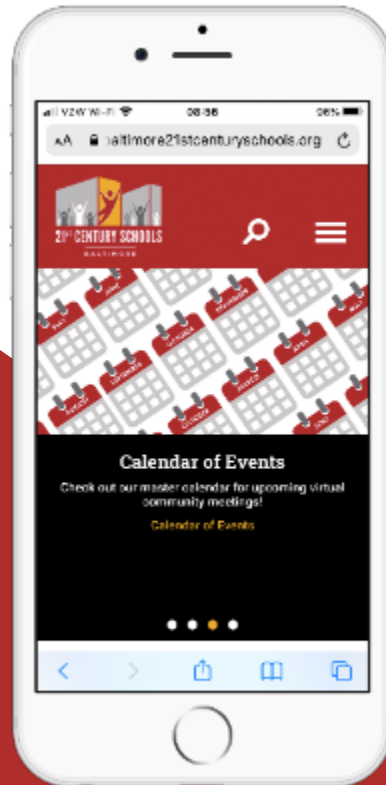

Questions?

Program Contacts

Ivy D McNeill
Sr. Community & Public Relations Coordinator
IDMcNeill01@bcps.k12.md.us

Renee Stainrod
Community & Public Relations Manager
rastainrod@bcps.k12.md.us

Program Information

21st Century School Buildings Program Office
(443) 642-4600



21stCSBaltimore



21stCenturySchoolBuildingsProgram



21stCSBaltimore

Thank You!



This presentation was brought to you by the 21st Century School Buildings Program.

www.baltimore21stcenturyschools.org

21st Century School Buildings Program

Baltimore City Public Schools
200 East North Avenue Room 407-B
Baltimore, MD 21202
(443) 642-4600

Cynthia Smith

Executive Director, Facilities Planning, Design & Construction
21st Century School Buildings Program

Gary McGuigan

Executive Vice President, Capital Development Division
Maryland Stadium Authority

Debra Y. Brooks

Executive Director
Mayor's Office of Children and Family Success

Alex Donohue

Interim Executive Director
Interagency Commission on School Construction

BALTIMORE CITY
PUBLIC SCHOOLS

