



21st Century School Buildings Program

HIGHLANDTOWN ELEMENTARY/MIDDLE SCHOOL #237

COMMUNITY MEETING Design Development | November 19, 2020



Introductions

Renee Stainrod

Manager, Community & Public Relations
21st Century School Buildings Program

Alicia Thomas

Sr. Coordinator, Community & Public Relations
21st Century School Buildings Program

Michael McBride

Design Director
21st Century School Buildings Program

Tim Cober

Project Manager
Maryland Stadium Authority

Ana Castro

Principal
JRS Architects

Agenda

- . **Design Update**
- . **Existing Building**
- . **Site Plan**
- . **Floor Plans**
- . **Exterior Views**
- . **Timeline**
- . **Q+A**

- Since our last meeting we have worked with 21st Century Schools and the community to clearly identify community use space potential in the building.
- Based on feedback from last meeting we have also developed the exterior spaces for review tonight.

Design

Existing Building

Y ↑



Ground Level



First Level

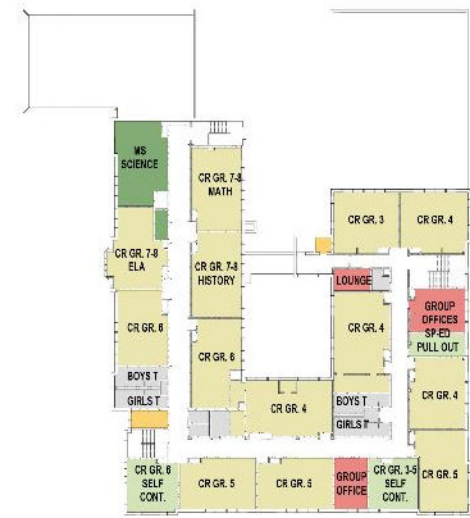

Second Level



- 80,422 square feet
- Originally constructed in 1926 in a collegiate, Gothic style
- Renovation and addition in 2007
- Operating at 32% over current capacity



SF = square footage

Design

Floor Plan - Ground Level

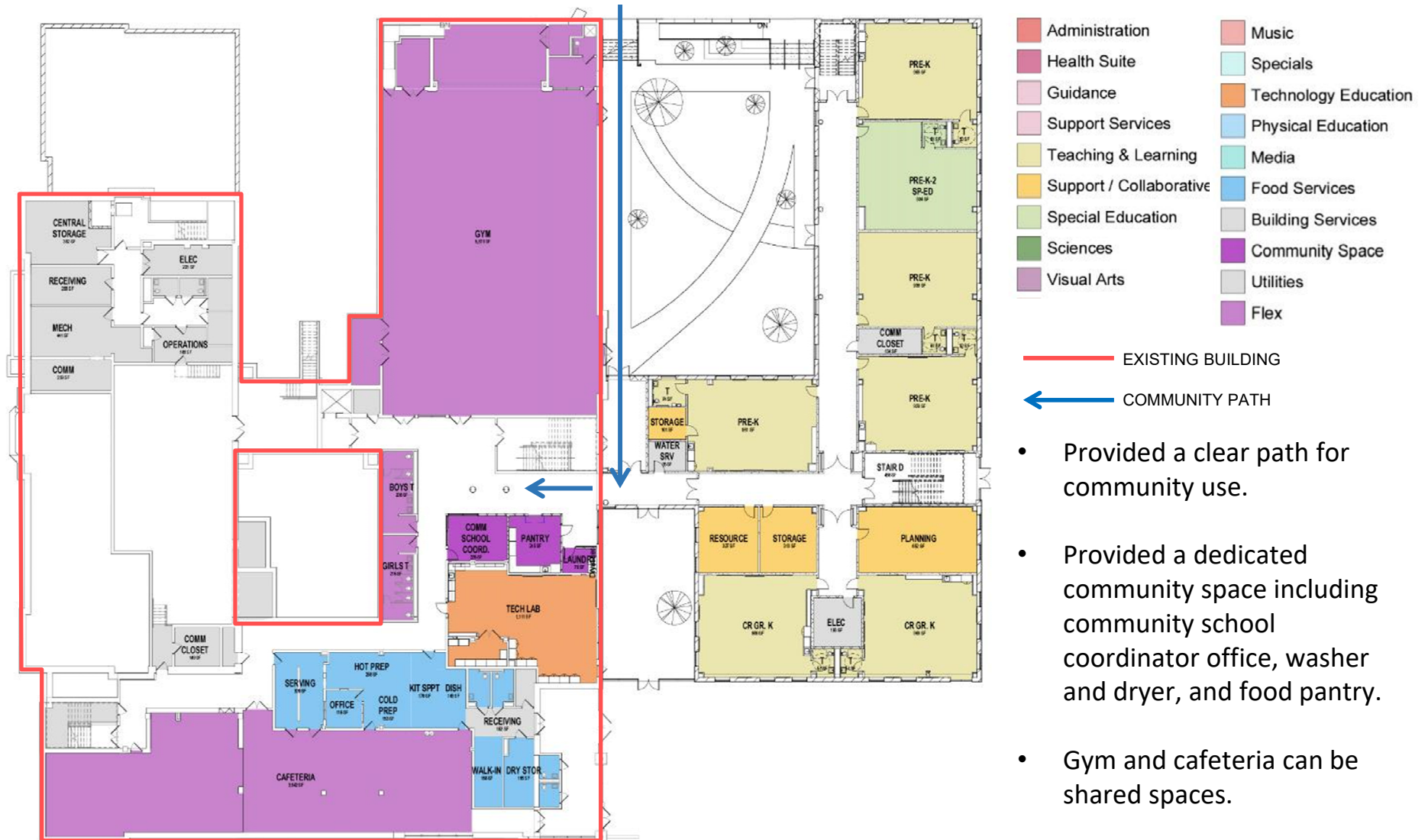

Design

Floor Plan - First Level

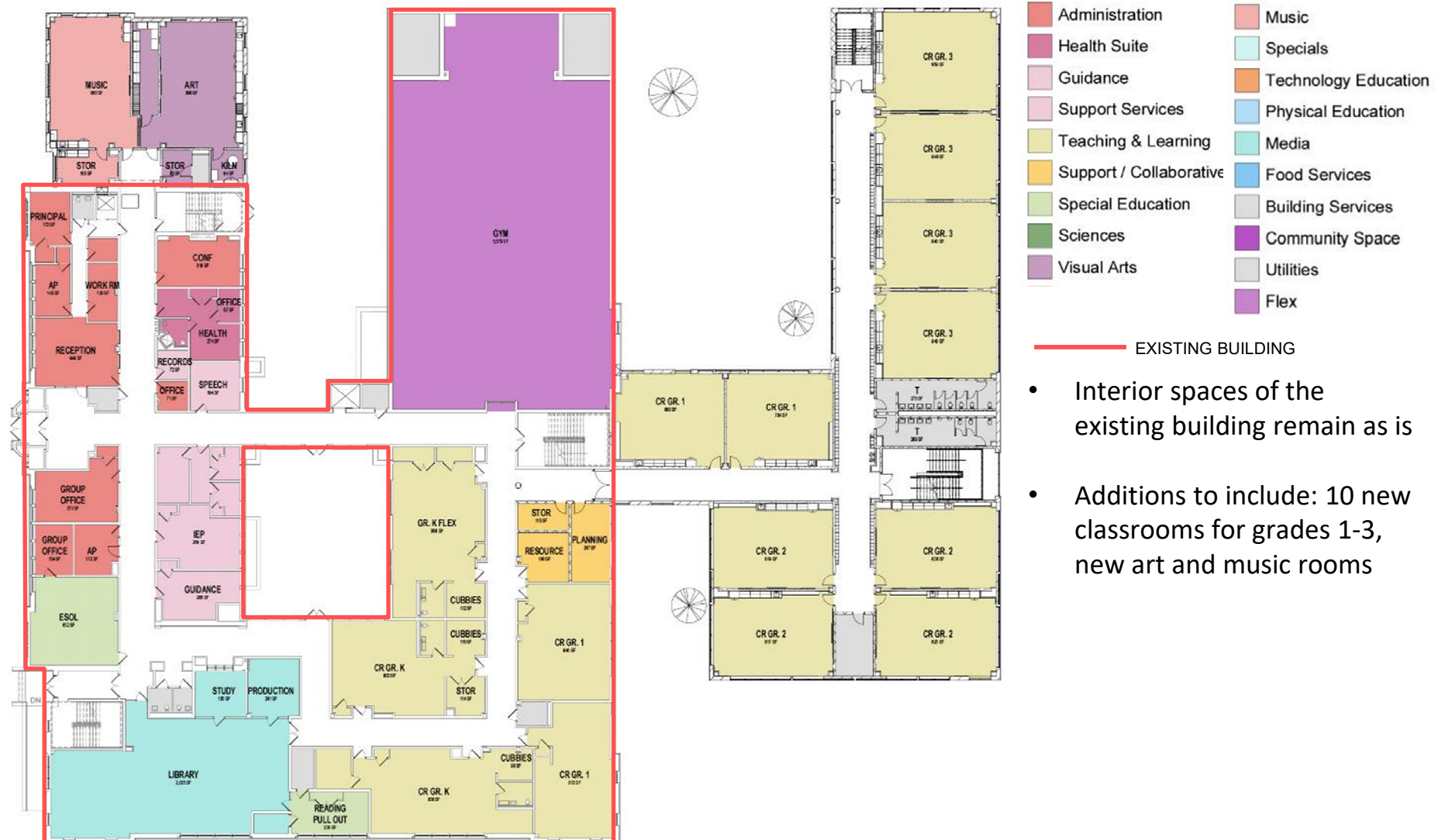

Design

Floor Plan - Second Level















Design

Timeline*



Summer 2021

Design: 10-12 Months

Dates subject to change*

Meeting #5

Concept

Meeting #6

Schematic

Meeting #7

Design Development

Meeting #8

Final Drawings

Questions?

CONTACTS

Renee Stainrod

rastainrod@bcps.k12.md.us

Alicia Thomas

AThomas03@bcps.k12.md.us

21st Century School Buildings

Program Office

(443) 642-4600

www.baltimore21stcenturyschools.org

Social Media



21stCSBaltimore



21stCSBaltimore



21stCenturySchoolBuildingsProgram

Thank You!



This presentation is brought to you by the
21st Century School Buildings Program.

www.baltimore21stcenturyschools.org

21st Century School Buildings Program

Baltimore City Public Schools
200 East North Avenue Room 407-B
Baltimore MD 21202
(443) 642-4600

Dorothy Hellman

Executive Director, 21st Century School Buildings Program
Baltimore City Public Schools

Gary McGuigan

Senior Vice President, Capital Development Division
Maryland Stadium Authority

Robert Gorrell

Executive Director, Public School Construction Program
State of Maryland

